

Typical generic strapping requirements for a 275 gal. or 220 gal. oval oil tank.

Figure #2201

Drawings NTS

Provide blocking between wall and tank, blocking must be secured to wall.

Use washer to support strap.

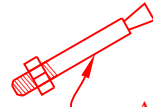

Approved concrete anchor bolts must be used.

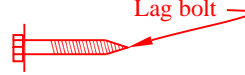

Lag bolt

(1) $\frac{3}{8}$ " dia. X 3" lag bolt, w/heavy duty washer, into blocking or (3) #12 X $1\frac{1}{2}$ " wood screws into studs (each end).

Alternate method of attaching strap to studs.

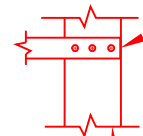

$\frac{3}{8}$ " dia. approved concrete expansion bolts, embedded 3" min. @ each end, w/ heavy duty round or square washers.

$1\frac{1}{4}$ " dia. min. X $\frac{1}{8}$ " thick



Strap must be a min. of 6" below radius at top of tank.

$1\frac{1}{4}$ " wide X 16 gage strap min.

When pieces of pipe are used as legs they must be of schedule 40 pipe and threads must be fully engaged at tank and flange connections. Bottom of tank must not be more than 12" above floor level.

Attach pipe flanges to concrete w/(2) $\frac{1}{4}$ " dia. approved concrete expansion bolts. (embedded 2" min.)

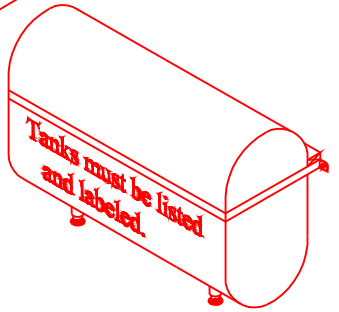

275 gal. oval tanks are approximately 60 inches in length, 220 gal. are slightly shorter. Height and width dimensions are approximate.



Concrete wall

275 or 220 gal. oval tank

Typical Basement Installation

Existing concrete slabs

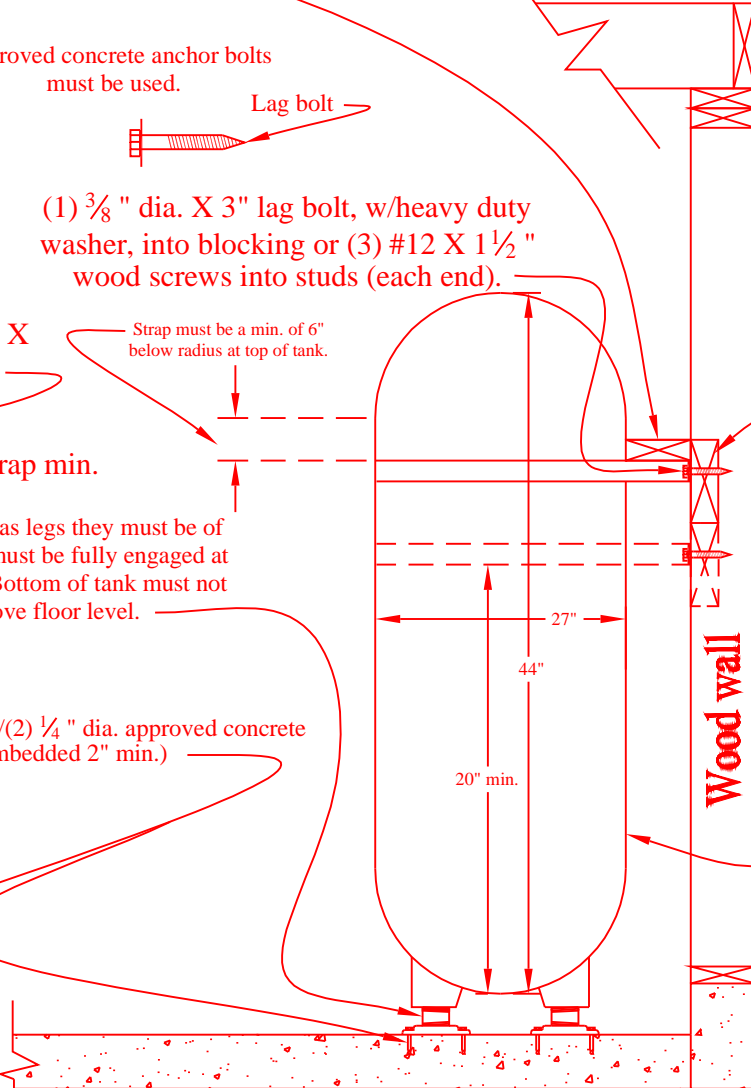

Wood wall

Typical Garage Installation

For oil tanks installed in other locations, contact your local jurisdiction.